

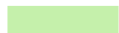

# IAQ Map Legend - Winter Operation

 Natural ventilation: Operable windows and/or louvres should be used to manage fresh air, balancing thermal comfort and ventilation.

 Mechanical ventilation: Fresh air is introduced by the heating, ventilation and air conditioning system when in operation. Windows can remain closed and no action is required by the school.

 UV-C Lights: Portable UV-C units have been provided to these classrooms to neutralise airborne virus particles, while further ventilation improvements are scoped. In these rooms, the systems must be in operation when the room is occupied.

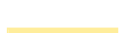
Note: White spaces are to be used in accordance with COVID-19 requirements and current health advice.

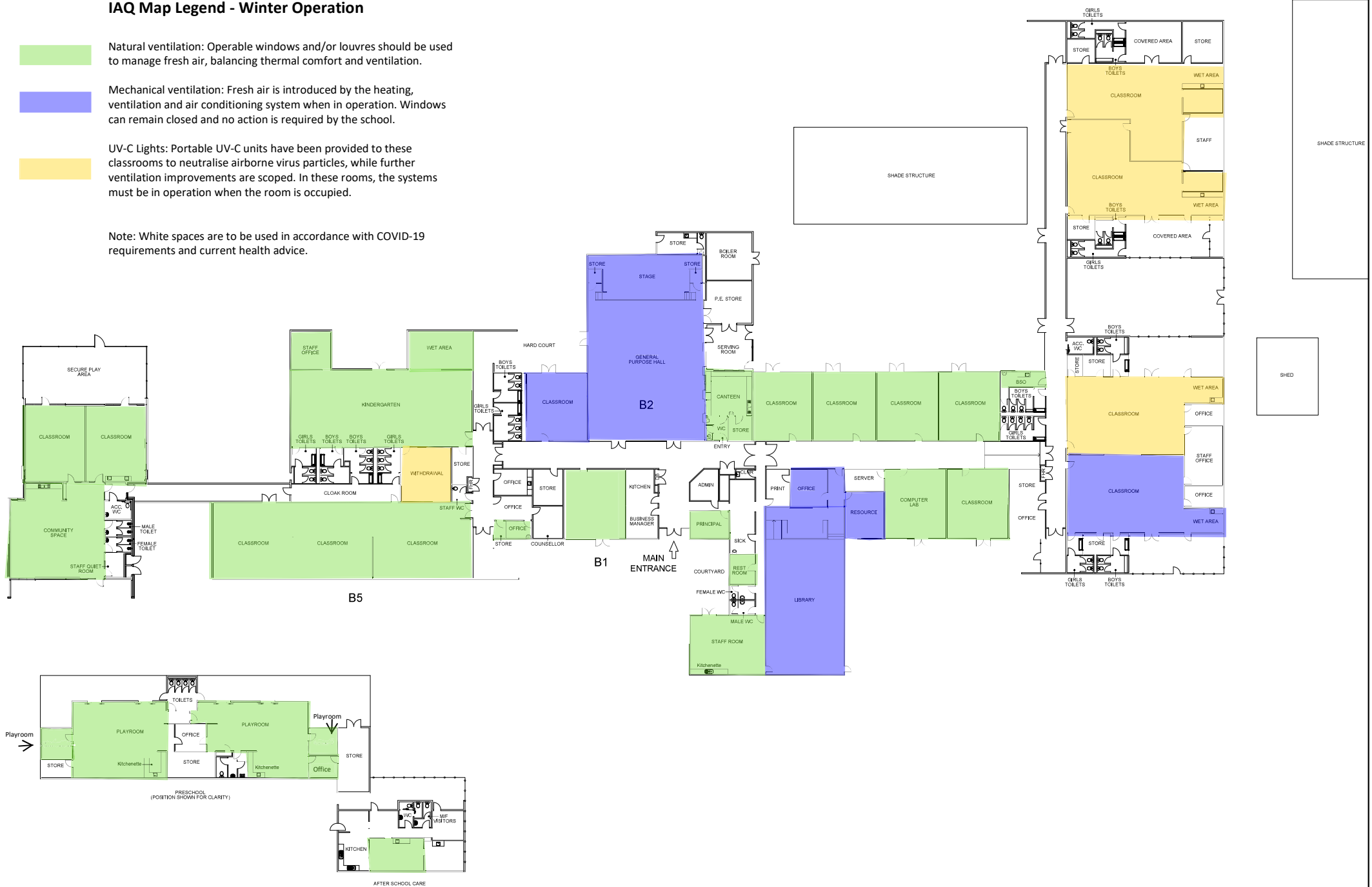

ISSUE	AMENDMENT	DRAWN	VER'D	APP'D	DATE

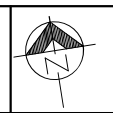

SCALE  
**1:400**  
DATE  
**JAN 2017**  
DRAWING SHEET SIZE = A3



PROJECT  
**EVATT PRIMARY SCHOOL  
INFRASTRUCTURE & CAPITAL WORKS  
SCHOOL LAYOUT PLAN**